

## Cell 200 Series

- designed for tubes 48 - 51 mm (1 7/8" - 2")
- supplied with M12 closing bolt
- mounting hole suitable for up to 13 mm (1/2") bolt

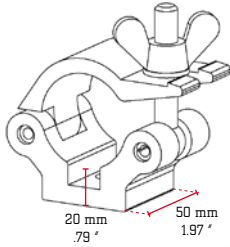

- made from ultra high tensile aluminium alloy
- professional micropercussion marking
- highly polished surface
- anodized versions available on special request



Ø 48-51 mm  
1 7/8"-2"

### CELL 201 CLAMP BASIC

SWL	Weight	
500 Kg	0,50 Kg	basic Clamp can be used for welding or construction of special items
1102 lbs	1.10 lbs	

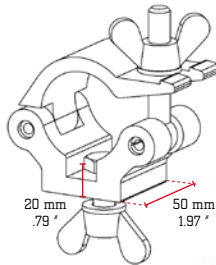

Ø 48-51 mm  
1 7/8"-2"

### CELL 202 CLAMP WITH BOLT AND WINGNUT

SWL	Weight	
500 Kg	0,59 Kg	clamp supplied with M12 x 35 bolt and wingnut
1102 lbs	1.30 lbs	

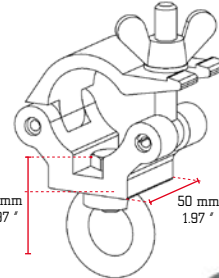

Ø 48-51 mm  
1 7/8"-2"

### CELL 203 CLAMP WITH LIFTING EYE

SWL	Weight	
300 Kg	0,65 Kg	clamp supplied with steel eye for rope or cable attachment
661 lbs	1.43 lbs	

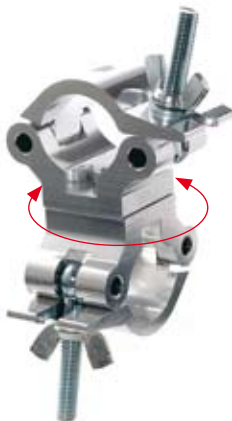
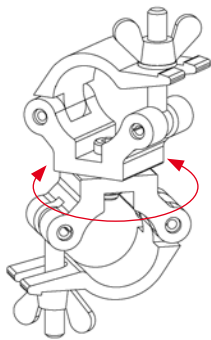

Ø 48-51 mm  
1 7/8"-2"

### CELL 204 SWIVEL COUPLER

SWL	Weight	
500 Kg	1,00 Kg	set of two clamps free to rotate 360° for connection two tubes
1102 lbs	2.20 lbs	

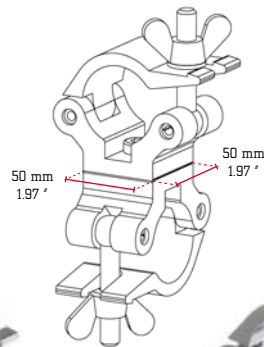

Ø 48-51 mm  
1 7/8"-2"

### CELL 205 90° FIXED COUPLER

SWL	Weight	
500 Kg	1,00 Kg	set of two clamps fixed at 90° to each other for connection of two tubes
1102 lbs	2.20 lbs	

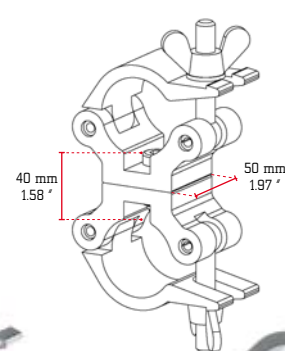

Ø 48-51 mm  
1 7/8"-2"

### CELL 206 PARALLEL COUPLER

SWL	Weight	
500 Kg	1,00 Kg	set of two clamps fixed parallel to each other for connection of two tubes
1102 lbs	2.20 lbs	

### CELL 213 HORIZONTAL ATTACHMENT

L1	L2	L3	
250 mm	500 mm	750 mm	50 x 2 mm also available in custom lengths
9.84'	19.69'	29.53'	

Ø 48-51 mm  
1 7/8"-2"

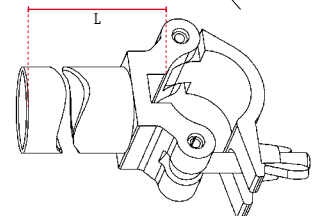
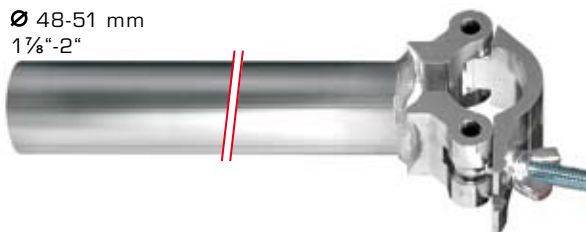

## Cell 200 Series

- designed for tubes 48 - 51 mm (1 7/8" - 2")
- supplied with M12 closing bolt
- mounting hole suitable for up to 13 mm (1/2") bolt



- made from ultra high tensile aluminium alloy
- professional micropercussion marking
- highly polished surface
- anodized versions available on special request

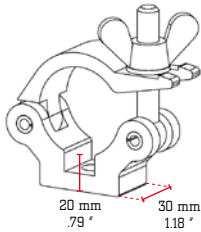

Ø 48-51 mm  
1 7/8"-2"

### CELL 207

SLIM CLAMP BASIC

SWL	Weight	
300 Kg	0,30 Kg	slim basic clamp can be used for welding or construction of special items
661 lbs	0.66 lbs	

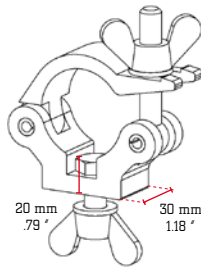

Ø 48-51 mm  
1 7/8"-2"

### CELL 208

SLIM CLAMP WITH BOLT + NUT

SWL	Weight	
300 Kg	0,39 Kg	slim clamp supplied with M12 x 50 bolt and wingnut
661 lbs	0.86 lbs	

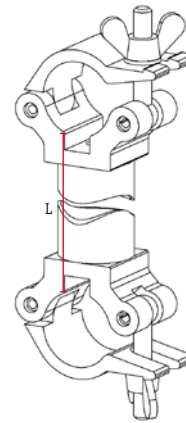

Ø 48-51 mm  
1 7/8"-2"

### CELL 209

EXTENDED PARALLEL COUPLER

L1	L2	L3	
250 mm	500 mm	1000 mm	set of two clamps connected with aluminum tube in various lengths for parallel tube connections • custom lengths available
9.84"	19.69"	39.37"	

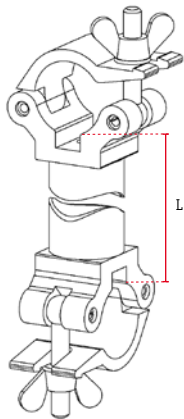

Ø 48-51 mm  
1 7/8"-2"

### CELL 210

EXTENDED 90° FIXED COUPLER

L1	L2	L3	
250 mm	500 mm	1000 mm	set of two clamps connected with aluminum tube in various lengths for 90° tube connections • custom lengths available
9.84"	19.69"	39.37"	

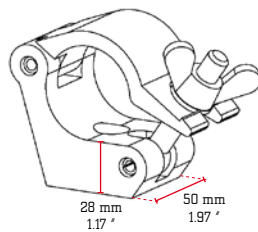

Ø 48-51 mm  
1 7/8"-2"

### CELL 211

SIDE CLAMP

SWL	Weight	
500 Kg	0,55 Kg	side clamp is ideal for using with trusses • substitute for claw clamp
1102 lbs	1.21 lbs	

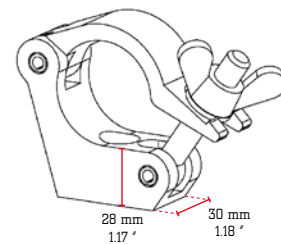

Ø 48-51 mm  
1 7/8"-2"

### CELL 212

SLIM SIDE CLAMP

SWL	Weight	
300 Kg	0,35 Kg	side clamp is ideal for using with trusses • substitute for claw clamp
661 lbs	0.77 lbs	